



Color: Bronze

Weight: 4.1 lbs

|                     |              |
|---------------------|--------------|
| <b>Project:</b>     | <b>Type:</b> |
| <b>Prepared By:</b> | <b>Date:</b> |

| Driver Info |                   | LED Info       |                   |
|-------------|-------------------|----------------|-------------------|
| Type        | Constant Current  | Watts          | 20/16/12W         |
| 120V        | 0.20A/0.15A/0.10A | Color Temp     | 3000K/4000K/5000K |
| 208V        | 0.10A/0.08A/0.06A | Color Accuracy | 82-84 CRI         |
| 240V        | 0.09A/0.07A/0.06A | L70 Lifespan   | 100,000 Hours     |
| 277V        | 0.08A/0.07A/0.05A | Lumens         | 1,174-2,043 lm    |
| Input Watts | 11.18-19.32W      | Efficacy       | 93.1-115.7 lm/W   |

## Technical Specifications

### Field Adjustability

#### Field Adjustable:

Field Adjustable Light Output:  
20W/16W/12W (factory default 20W)  
Color Temperature Selectable:  
3000K, 4000K and 5000K (factory default 5000K)  
On/Off Photocell (factory default "On")

### Performance

#### Lifespan:

100,000-Hour LED lifespan based on IES LM-80 results and TM-21 calculations

### LED Characteristics

#### LEDs:

Long-life, high-efficacy, discrete, surface-mount LEDs

### Electrical

#### Driver:

Constant Current, Class 1, 120-277V, 50/60 Hz:  
20W: 0.20A, 208V: 0.10A, 240V: 0.09A, 277V: 0.08A  
16W: 120V: 0.15A, 208V: 0.08A, 240V: 0.07A, 277V: 0.07A  
12W: 120V: 0.10A, 208V: 0.06A, 240V: 0.06A, 277V: 0.05A

#### THD:

20W: 17.7% at 120V, 13.7% at 277V  
16W: 17.9% at 120V, 13.7% at 277V  
12W: 16.5% at 120V, 12.1% at 277V

#### Power Factor:

20W: 98.5% at 120V, 93.8% at 277V  
16W: 98.4% at 120V, 91.7% at 277V  
12W: 98.3% at 120V, 87.4% at 277V

#### Aux Power Supply:

No

#### Dim to Off:

No

#### Photocell:

120-277V selectable photocell that can be turned on and off.

#### Surge Protection:

2kV

### Construction

#### Cold Weather Starting:

The minimum starting temperature is -40°C (-40°F)

#### Ambient Temperature:

Suitable for use in up to 45°C (113°F)

#### Housing:

Die-cast aluminum

#### Lens:

Glass

#### Gaskets:

High-temperature silicone

#### Finish:

Formulated for high durability and long-lasting color

#### Green Technology:

Mercury and UV free. RoHS-compliant components.

### Compliance

#### UL Listed:

Suitable for wet locations

#### IESNA LM-79 & LM-80 Testing:

RAB LED luminaires and LED components have been tested by an independent laboratory in accordance with IESNA LM-79 and LM-80.

#### IP Rating:

Ingress protection rating of IP65 for dust and water

### Installation

#### Mounting:

Wall mount

## Technical Specifications (continued)

### Optical

#### BUG Rating:

20W: B1 U3 G1

16W: B1 U3 G1

12W: B1 U3 G1

### Other

#### 5 Yr Limited Warranty:

The RAB 5-year, limited warranty covers light output, driver performance and paint finish. RAB's warranty is subject to all terms and conditions found at [rablighting.com/warranty](http://rablighting.com/warranty).

## Dimensions

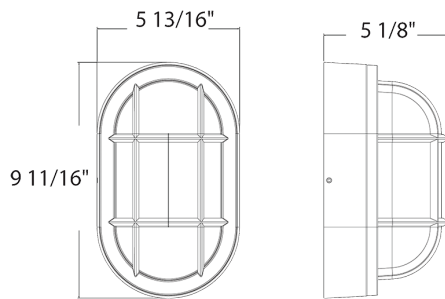

## Features

- 100,000-hour LED Life
- On/Off photocell
- 5-Year, limited warranty

## Ordering Matrix

| Family | Wattage   | Color Temp                             | Shape                     | Finish                      | Driver           | Options                  |
|--------|---|--|---------------------------|-----------------------------|------------------|--------------------------|
| BULKH  | 20  |  |                           |                             |                  |                          |
|        | 10 = 10/8/6W<br>15 = 15/12/9W<br>20 = 20/16/12W | Blank = 3000/4000/5000K CCT Adjustable | Blank = Oval<br>R = Round | Blank = Bronze<br>W = White | Blank = 120-277V | Blank = On/Off Photocell |