



Color: Metal

Weight: 0.7 lbs

Project:	Type:
Prepared By:	Date:

Technical Specifications

Performance

Description:

6-inch LED downlight module with universal (120-277V) driver for HALELED

Product Type:

Recessed Downlights

Input Wattage:

18W

L70 Lifespan:

50,000-Hour LED lifespan based on IES LM-70 results

Dimming:

Yes, See Dimmer Compatibility List

Compliance

UL Listed:

Suitable for damp locations

FCC:

Complies with Part 15B of the FCC Rules

Trade Agreements Act Compliant:

This product is a product of Cambodia and a "designated country" end product that complies with the Trade Agreements Act

Electrical

THD:

≤20%

Power Factor:

0.9

Operating Frequency:

50/60Hz

Construction

Material:

Metal

Trim Style:

Smooth Trim

Operating Temperature Range:

-20°C - 40°C (-4°F - 104°F)

Installation

Mounting:

Recessed ceiling

LED Characteristics

Color Stability:

LED color temperature is warrantied to shift no more than 200K in color temperature over a 5-year period

Color Uniformity:

RAB's range of Correlated Color Temperature follows the guidelines of the American National Standard for Specifications for the Chromaticity of Solid State Lighting (SSL) Products, ANSI C78.377-2017.

Other

Warranty:

RAB warrants that our LED products will be free from defects in materials and workmanship for a period of five (5) years from the date of delivery to the end user, including coverage of light output, color stability, driver performance and fixture finish. RAB's warranty is subject to all terms and conditions found at rablighting.com/warranty.

Dimensions

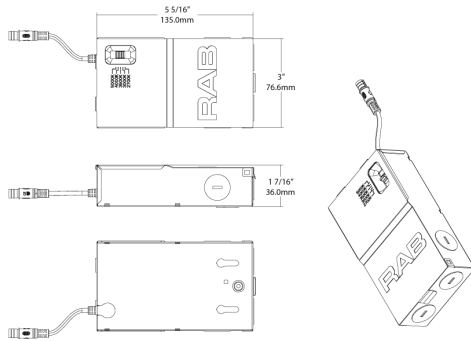

Features

45-degree optical lens provides uniform light distribution

Dimmable, see Dimmer Compatibility List

IC and airtight rated

Separate snap-in color trims available in round, square, smooth and baffle for in-field installation

50,000-Hour LED lifespan

5-Year, no compromise warranty