



KT-LALED-XA-SM-KIT

SURFACE MOUNTING KIT

DESCRIPTION

Surface mount kit for Keystone Linta Series Architectural Pendant Fixtures

APPLICATION

Fits all corresponding KT-LALED fixtures for recess mount applications

PRODUCT FEATURES

Includes surface mount bracket, j-box cover, safety cables, and mounting hardware



PRODUCT SPECIFICATIONS

CATELOG NUMBER	DESCRIPTION
KT-LALED-2A-SM-KIT	Surface Mounting Kit for 2' Fixtures
KT-LALED-3A-SM-KIT	Surface Mounting Kit for 3' Fixtures
KT-LALED-4A-SM-KIT	Surface Mounting Kit for 4' Fixtures
KT-LALED-8A-SM-KIT	Surface Mounting Kit for 8' Fixtures

PHYSICAL SPECIFICATIONS

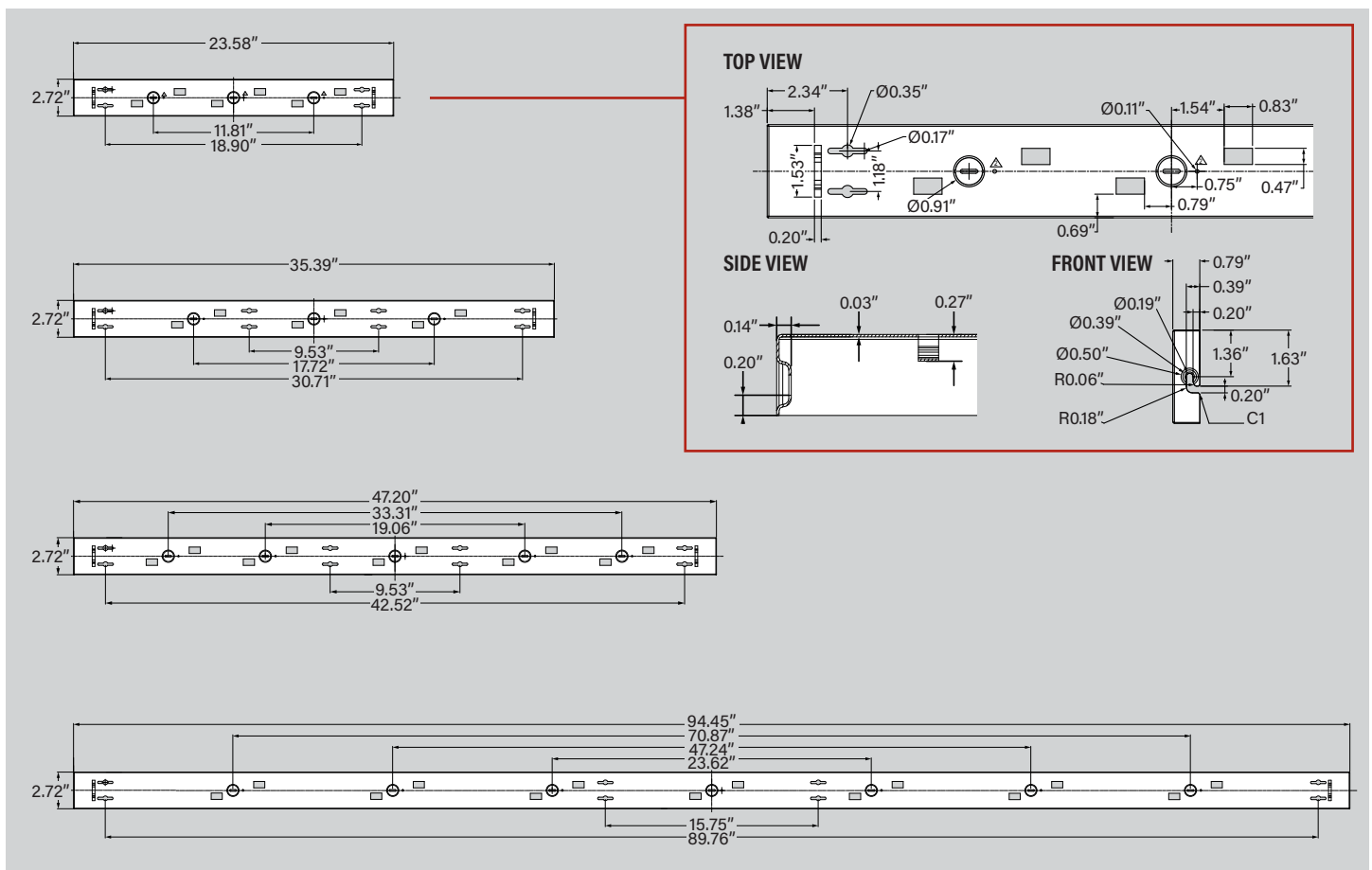

KT-LALED-XA-SM-KIT SURFACE MOUNTING KIT

INSTALLATION INSTRUCTIONS

1. Determine location to mount the surface mount kit. Open pre-punched KO's as needed to align with incoming supply power. Ensure power is turned off. Mount bracket to the ceiling and secure via screws (and drywall anchors if needed.)

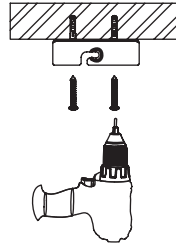

2. Install U brackets with safety cables onto both ends of the fixture, using the same mounting holes as intended for the fixed cable grippers. Ensure screw head faces "out." Once complete, hook the safety cables from the fixture to the slots on the surface mount bracket.

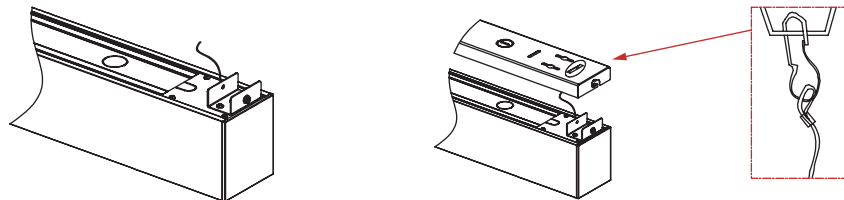

3. Complete all input wire and dimming connections as needed. Connections should be made inside a suitable junction box in the ceiling, or inside the fixture wiring compartment. (No wiring harness included for surface mount installations.) Adjust Wattage, CCT, and directional switches as needed. (100% downlight recommended for surface mount installation.)

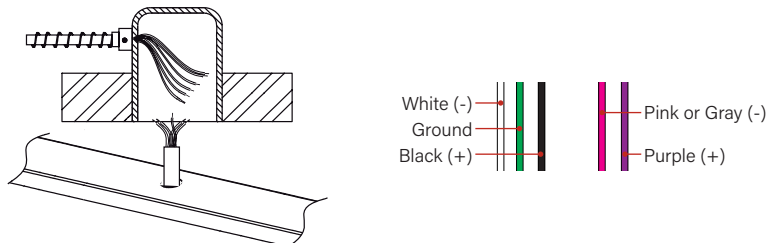

4. Insert the fixture up into the surface mount bracket, ensuring wiring is not pinched, such that that the screws in the U brackets slide into the slots on either end of the surface mount bracket. Tighten screws on both ends to ensure the fixture is permanently secured. Restore power to fixture.

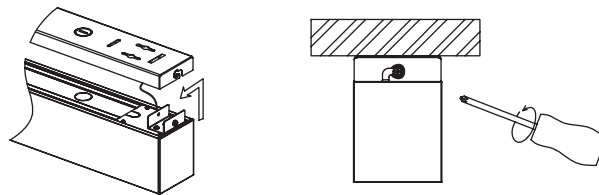



KT-LALED-XA-SM-KIT

SURFACE MOUNTING KIT

ORDERING INFORMATION

CATALOG NUMBER	UPC	EASY CODE
KT-LALED-2A-SM-KIT	843654157870	PZA-14
KT-LALED-3A-SM-KIT	843654157887	UON-33
KT-LALED-4A-SM-KIT	843654156811	UDG-40
KT-LALED-8A-SM-KIT	843654156828	YUT-17

CATALOG NUMBER BREAKDOWN

KT-LALED-XA-SM-KIT

1
2
3
4
5
6
7

- 1** Keystone Technologies
- 2** Linear Architectural Fixture
- 3** LED
- 4** Nominal Size
- 5** Series/Form Factor
- 6** Surface Mount
- 7** Kit