



KTSL-CS1-UV-JM-DT

BLUETOOTH WIRELESS CEILING SENSOR

DESCRIPTION

Bluetooth mesh wireless ceiling controller for SmartLoop system with integrated Daylight, PIR, and Ultrasonic sensors.

APPLICATION

Ideal for small- to medium-size systems, such as schools and offices.



Bluetooth®



RoHS Compliant



5 YEAR WARRANTY

PRODUCT FEATURES

- Use of a relay and 0-10V dimming enables compatibility with many standard industry fixtures
- Installs into standard 4in trade size octagon junction box
- Commissioned via SmartLoop mobile app for iPhone and Android
- Controlled via SmartLoop mobile app and keypads
- Integrated Daylight, PIR, and Ultrasonic sensors
- Utilizes Bluetooth mesh technology for reliable and secure wireless communication
- Intelligent relay control software reduces wear to extend relay life
- Power outage recovery defaults to automatic on state
- Indicator LED communicates device status

ELECTRICAL SPECIFICATIONS

Input Power	120 -277VAC, 50-60Hz
Standby Power	<1W
Max Load Current	6.0A (720W @ 120Vac, 1662W @ 277Vac)
RF Transmit Power	8dBm
Sensor Wires	Class 2
Max Motor Load	1/6hp
Turn-on Delay Time	< 0.5s
Relay Turn-off Time	2s
Max 0-10V Sinking Current	48.5mA
Wireless Frequency	2.4GHz
Wireless Range (Open Air)	100ft
Wireless Protocol	Bluetooth 5.0
Sensor Detection Height	15' Max
Sensor Detection Angle	120°
Daylight Harvesting Range	30-2500 lux



KTSL-CS1-UV-JM-DT

BLUETOOTH WIRELESS CEILING SENSOR

ENVIRONMENTAL SPECIFICATIONS

Operating Temperature	0°C/32°F to 55°C/131°F
Storage Temperature	- 30°C/- 22°F to 85°C/185°F
Humidity	5-90%
Lifetime Rating	50,000 hrs
Moisture and Dust Rating	IP20

SAFETY AND EMC COMPLIANCE

UL/cUL	UL8750
FCC	Part 15.247

PHYSICAL SPECIFICATIONS

Mounting	Junction Box
Length	4.70"
Width	3.21"
Height	2.38"
Weight	6.0 oz.
Case Material	Plastic

WIRING DIAGRAM

OPTION 1: DIRECT HARDWIRED CONTROL

OPTION 2: WIRELESS ASSOCIATE CONTROL

Name	Function	Color	Gauge	Type	Length	Strip Length
L	Input Hot	Black	18AWG	Solid	12.59"	0.39"
N	Neutral	White				
L1	Switched Hot Out	Red				
10V+	Dimming Level	Purple				
10V-	Low Voltage Common	Pink				

KTSL-CS1-UV-JM-DT

BLUETOOTH WIRELESS CEILING SENSOR

APPLICATION GUIDANCE

The KTSL-CS1-UV-JM-DT is designed to function in two different types of application: direct hardwired control, as well as wireless association control, as outlined below.

DIRECT HARDWIRED CONTROL

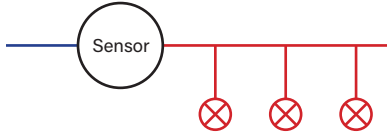

Connect otherwise non-Smartloop lights and appliances to the relay output of the sensors to automatically control them via motion sensing along with the additional features and functions Smartloop offers.

- Power Supply
- Relay Output
- ⊗ Smartloop Lights
- ⊗ Non-Smartloop lights

WIRELESS ASSOCIATION CONTROL

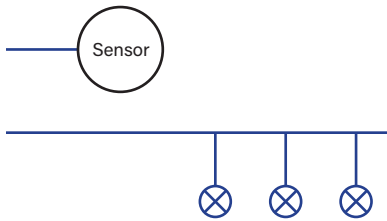

The sensor can be wirelessly associated with an existing group of Smartloop lights (usually control nodes only, without their own PIR sensor embedded) without the need for any direct wiring connections, to automatically control them via motion sensing. In-order to do this, the motion sensor setting must be ENABLED for each Smartloop light in the app, even though they do not physically have their own sensor. This allows for the KTSL-CS1-JM-DT to speak with them wirelessly on the network and serve as their "sensor".

Note: to avoid unintended operational conflicts, ensure the hold time, standby time, and standby dim % settings match for the KTSL-CS1-JM-DT AND the Smartloop lights it is being wirelessly associated with.

LENS COVERAGE

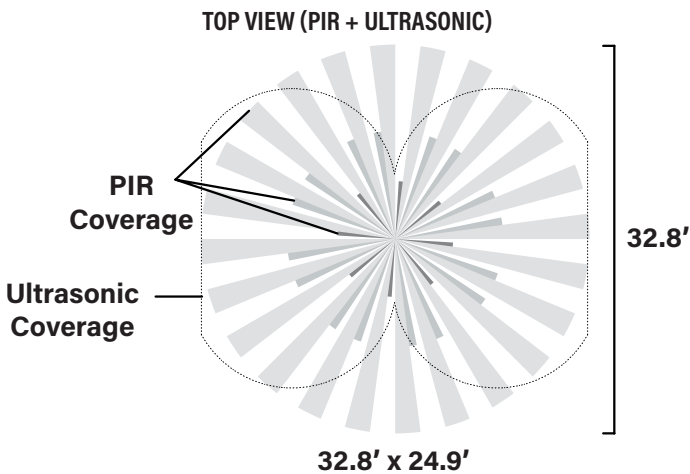
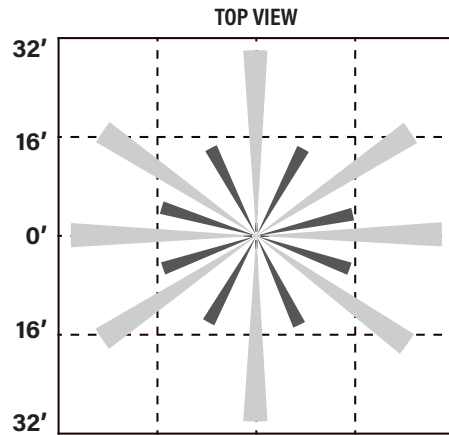
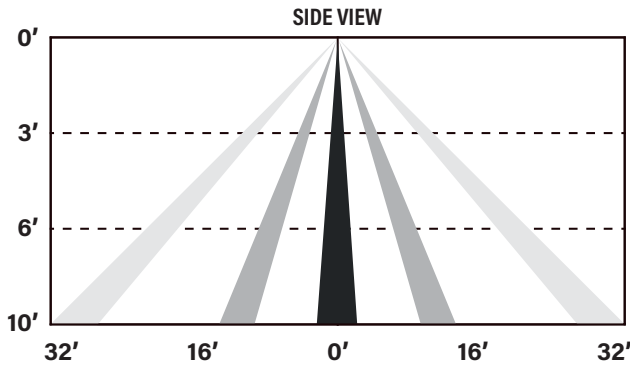

COMMISSIONING

1. Search for and download the Smartloop app (logo pictured to the right) from the App Store or Google Play Store
2. The **Devices** page is used to add & program the sensors in a region. Press **Devices** in the bottom pane to access the page.
3. Press **Sensors** and then **+** to add new sensors to a region.
 - a. The app will begin searching for available sensors.
 - b. Check each sensor to be commissioned to the region.
 - c. Press **Add** to confirm selections. The selected sensors will now appear on the **Devices > Sensors** page.
4. The sensors can be controlled and adjusted in the app. To navigate to the sensor, press **Devices** and then **Sensors** to see all available sensors that have been added to a region.
 - a. Icon A allows for manual on/off and dimming control.
 - b. Icon B allows for motion sensor settings (such as sensitivity, triggering technology, hold times, etc).
 - c. Icon C allows for assigning the sensor to existing groups.



For further commissioning information and instructions, please scan the QR code to access the Smartloop user manual.

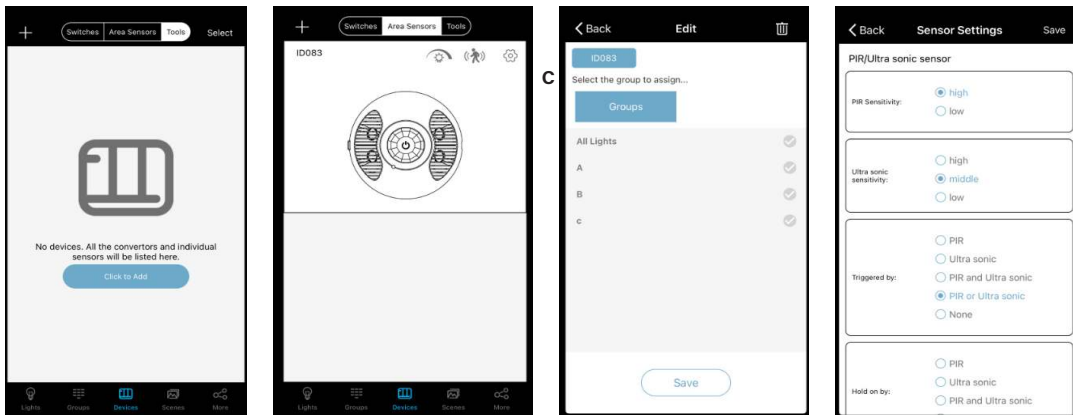



KTSL-CS1-UV-JM-DT

BLUETOOTH WIRELESS CEILING SENSOR

ORDERING INFORMATION

ORDER CODE	PACK QTY.	UPC	EASY CODE	DLC PRODUCT ID
KTSL-CS1-UV-JM-DT	10	843654169651	TXI-69	TBD

CATALOG NUMBER BREAKDOWN

KTSL-CS1-UV-JM-DT

1
2
3
4
5
6

- 1** Keystone Technologies SmartLoop
- 2** Ceiling Sensor
- 3** Design Style 1
- 4** Universal Voltage
- 5** Junction Box Mountable
- 6** Dual Tech Sensor Technology