

# NHIOICD-16 / NHIOICDCP-16

1" Iolite IC Air-Tight New Construction Housing

Source: 9W or 10W LED

600lm

Type

Project

Catalog No.

Notes

## PRODUCT DESCRIPTION

New construction housing for use in insulated ceilings can be in direct contact with insulation. Air-tight construction provides energy savings by reducing the flow of air through the ceiling. Patented design allows for easy, tool-less removal of the driver.

## SPECIFICATION

**Housing:** 0.040" Aluminum shallow housing can be installed in 1/2" ceiling thickness, an extension collar (NIO-1EXTC2) is available for ceiling thickness up to 2".

**Patented Driver Assembly:** Allows driver to slide out of housing without tools from the room side.

**Air Flow Restriction:** Meets requirements of Air-Tight (AT) <2CFM (cubic feet per minute) in accordance with ASTM-283 Air-Tight requirements.

**Clearance:** "IC" Insulated ceiling housings are direct contact rated. Not to be used in direct contact with spray foam insulation.

**Bar Hangers:** Two 13-3/4" to 24-1/2" adjustable bar hangers with captive nails are included on housing. Bar hangers are parallel to junction box, but can be repositioned 90° perpendicular to junction box if desired. "L"-shaped bar hanger foot to align to bottom of construction joist. A T-bar notch allows for easy installation in a suspended ceiling.

**Junction Box:** Pre-wired 25 cubic inch 0.064" thick galvanized steel, with seven 1/2" knockouts, four Romex® pryouts, and snap on covers. All leads are #18AWG wire, the ground wire is connected to the bottom, and quick connectors are supplied on all leads. Maximum of 8 no. 12 AWG through branch circuit conductors suitable for at least 90°C permitted in junction box. **Access above ceiling required** (use remodel housing and frame-in for access from room side)

ELECTRICAL	LE3	LE4
<b>Input Voltage</b>	120V	120-277V
<b>Input Power</b>	9W	10W
<b>Power Factor</b>	≥0.90	
<b>Dimming</b>	Triac / ELV	Triac / ELV / 0-10V
<b>Operating Temp.</b>	40°C max.	

## COMPATIBLE TRIMS & MONOPOINTS

CATALOG NO.	DESCRIPTION
<a href="#">NIOB-1RNB</a>	1" Round Bullnose (BWF)
<a href="#">NIOB-1SNB</a>	1" Square Bullnose (BWF)
<a href="#">NIOB-1RNG</a>	1" Round Straight Regress (BWF)
<a href="#">NIOB-1SNG</a>	1" Square Straight Regress (BWF)
<a href="#">NIOB-1RPH</a>	1" Round Pinhole (BWF)
<a href="#">NIOB-1RSL</a>	1" Round Adj. Slot Aperture (BWF)
<a href="#">NIO-1RNB</a>	1" Round Bullnose (NTF)
<a href="#">NIO-1SNB</a>	1" Square Bullnose (NTF)
<a href="#">NIO-1RNG</a>	1" Round Straight Regress (NTF)
<a href="#">NIO-1SNG</a>	1" Square Straight Regress (NTF)
<a href="#">NIOB-1RCY</a>	1" iPOINT Cylinder
<a href="#">NIOB-1RTC</a>	1" iPOINT Cone

**Emergency:** Housing can be specified with connections for emergency battery installation. Requires access above ceiling. Must specify battery with remote test switch separately (NEPK-07LEDUNV).

*Note: Emergency is not compatible with NHIOICDCP-16*

## LABELS AND LISTINGS

- cULus Listed for Damp Location (Wet Location when used with compatible trim)
- 5-Year Limited Warranty
- RoHS Compliant
- FCC compliant
- Patent #D824567S
- Meets or exceeds ASTM-283 Air-Tight requirements



## PRODUCT IMAGES AND DIMENSIONS

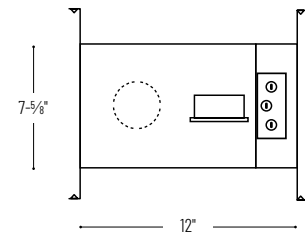
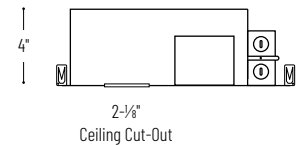

## 1" Iolite IC Air-Tight New Construction Housing - Compatible with NIOB-1 & NIO-1 reflectors

Housing Type	Driver / Dimming	Optional Emergency Wiring
<b>NHIOICD-16</b> = IC Air-Tight	<b>LE3</b> = 120V input; Triac / ELV dimming	/PEM = Remote Emergency
	<b>LE4</b> = 120-277V input; Triac / ELV / 0-10V dimming	
<b>NHIOICDCP-16</b> = Chicago Plenum	<b>LE3</b> = 120V input; Triac / ELV dimming	
	<b>LE4</b> = 120-277V input; Triac / ELV / 0-10V dimming	

## Optional Accessories

Description
<b>NEPK-07LEDUNV</b> = Remote Emergency Battery w/Test Switch
<b>NIO-1EXTC2</b> = Ceiling Extension Collar up to 2"

Example: **NHIOICD-16LE3** = 1" Iolite IC Air-Tight New Construction Housing, 120V input; Triac / ELV dimming